



Multimag TM II

Multijet Residential Meter - DN15 & DN20
Commercial and Industrial Applications - DN25 to DN50

The Multimag Cyble is an excellent multi-jet turbine water meter, ready for automated metering reading (AMR).

Following the increasing need of automation in the metering application, Multimag Cyble has been developed in order to provide very good and durable metrology performance combined with fully AMR capabilities.

FEATURES AND BENEFITS

- » Reliability
- » Robustness
- » Different versions
- » Operate in several conditions

Technology

Using high quality materials and exclusive measuring elements design, the water flows into the meters keeping the turbine balanced, reducing the wear and assuring stable metrological performance.

In addition to that the extra-dry registers, combined with magnetic transmission guaranty very durable accuracy.

Metrology

Equivalent to and better than class B meters according to ISO 4064:1993 standard and approved according to the new Directive 2004/22/CE (MID) for all sizes.

Standard Compliance

- » ISO 4064:2005
- » OIML R49-1:2006
- » MID 2004/22/CE

Main Characteristics

- » Enhanced design and technologies with longterm reliability
- » High quality engineering materials
- » Register can be oriented to allow easily reading
- » 100% of the products are calibrated on electronic test benches and all results can be provided
- » Robust against different types of frauds

TECHNICAL CHARACTERISTICS

Residential

Nominal diameter (DN)	mm	15	20				
Meter thread	inches	½"	¾"				
Body Lengths	mm	165	190				
MID Model Approval		LNE 18726					
Metrology Class (MID)		1.6 R100	1.6 R80	1.6 R50	2.5 R100	2.5 R80	2.5 R50
Installing positions		H	H	H	H	H	H
Minimum Flow Rate	Q ₁ L/h	16	20	32	25	31.2	50
Transitional Flow Rate	Q ₂ L/h	26	32	51	40	50	80
Permanent Flow Rate	Q ₃ m ³ /h	1.6	1.6	1.6	2.5	2.5	2.5
Overload Flow Rate	Q ₄ m ³ /h	2.0	2.0	2.0	3.1	3.1	3.1
Maximum allowed flow-rate	Q _{max} m ³ /h	3.0	3.0	3.0	5.0	5.0	5.0
Typical starting flow rate	L/h	7		12			
Maximum admissible pressure (MAP)	bar	16					
Pressure loss class at Q ₃	bar	0.63					
Pressure loss at Q _{max}	bar	< 1					
Temperature class		T50					
Flow profile sensitivity class		U _o / D _o					
Maximum reading	m ³	99999					
Minimum scale interval	L	0.02					

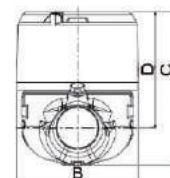
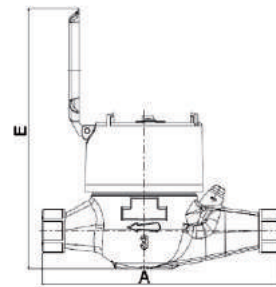

Residential Dimensions

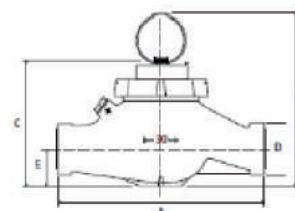

Commercial and Industrial

Nominal diameter (DN)	mm	25	30	40	50		
	inches	1"	1 ¼"	1 ½"	2"		
MID Approval Certificate		LNE - 23703					
Permanent Flow Rate	m ³ /h	4	6.3	4	6.3	10	16
Overload Flow Rate	m ³ /h	5	7.9	5	7.9	12.5	20
Q ₃ /Q ₁		50	63	50	63	50	50
Q ₂ /Q ₁		1.6					
Position		Horizontal					
Peak Flow	m ³ /h	7	10		20	30	
Pressure loss group at Q _n	bar	< 0.2	< 0.4	< 0.2	< 0.4	< 0.2	< 0.3
Maximum Admissible Temperature	°C	30					
Minimum Accidental Temperature for Short Periods (Water)	°C	50					

Dimensions - Residential

Nominal diameter (DN)	mm	15	20**
	inches	½"	¾"
Threads	mm	G ¾"	G 1"
A	mm	165	190
B	mm	80	80
C	mm	112	112
D	mm	88	88
E	mm	147	147
Entry hole diameter	mm	12.7	23

**Considering the Multimig Cyble Version

Dimensions - C&I

Nominal diameter (DN)	mm	25	30	40	50*
	inches	1"	1 ¼"	1 ½"	2"
A ISO	mm	260		300	
B	mm	190	222		250
C	mm	124	155		182
D	inches	G 1" ¼ B	G 1" ½ B	G 2" B	G 2" ½ B
E	mm	34.5	45		53
F	mm	103	128		132

*50mm flanged version (ISO or DIN length) upon request

Our company is the world's leading provider of smart metering, data collection and utility software systems, with over 8,000 utilities worldwide relying on our technology to optimize the delivery and use of energy and water.

To realize your smarter energy and water future, start here: www.itron.com

ITRON NOIDA - HEAD OFFICE

C - 7, Sector 3, Noida - 201 301
Uttar Pradesh

Phone: +91 120 465 6666

Fax: +91 120 465 6677

ITRON DEHRADUN - WORKS

Khasra No. 3903/3904, Majri Grant,
Lal Tappad Industrial Area,
Haridwar Dehradun Highway,
Lal Tappad,
District - Dehradun

Phone: +91 0135-2499083

ITRON MUMBAI

2122, C-Wing,
Oberoi Garden Estates, CTS No 47,
Village Chandivili, Sakinaka, Andheri (E)
Mumbai - 400 072, Maharashtra

Phone: +91 22 4015 2217 / 18

Fax: +91 22 4026 0914

ITRON BANGALORE

F-1, 1st Floor, No. 53/5, Jai Santoshimata
Complex, Opp Seshadripuram Law College
1st Main Road, Seshadripuram
Bangalore - 560020, Karnataka

Phone: +91 020-23563270

Mobile: +91 09845218310